



# Fabric Belt Conveyor

## Models

**FBC10, FBC12, FBC14, FBC16, FBC18, FBC20**

### Standard Features

- All Stainless Steel construction

### Warranty

- Two years parts and one year labor

## APPLICATION

The straight-line fabric belt motorized conveyor is designed for tray make-up in healthcare operations. Mobile or stationary, these units are designed for easy cleaning and long life. Since these units are built to customer specifications, some units may not be available in mobile configuration. Please consult factory.

## SPECIFICATIONS

Drive housing is 18-gauge stainless steel with 2"x2"x3/16" stainless steel with all welded angle and channel framework. Removable panels are provided for easy access. Drive is a totally enclosed fan cooled D.C. permanent magnet motor through worm gear speed reducer, sprockets, and roller chain. It has a fully lagged power roller with snubbed drive assembly providing 270° belt contact for a positive drive. Automatic belt tensioning device is provided to maintain tracking. Rollers are crowned to ensure proper tracking. Conveyor is furnished with side belt guides to also assist in belt tracking. Motor controlled with SCR power transmission group. SCR main control panel, located on drive end of conveyor, has speed control station with stop-start controls. SCR system includes dynamic braking. All controls are NEMA 4 watertight. Shafting is solid stainless steel with stainless steel sprockets. Bearings are self-aligning ball bearings sealed for life. Belt is fabric type Hycar Buena N. Rubber over woven synthetic carcass, which is FDA approved. Belt speed is adjustable with speeds ranging from approximately 0 to 40 feet per minute. Conveyor slider pan is formed of stainless steel die embossed discs to provide "air glide" ride and prevent friction drag between belt and pan. Die-formed crimp edge has straight turndown along the sides and is straight down on the ends. Belt terminates at drive end to provide flat top space for one tray. Supports are 1-5/8" O.D. 16-gauge stainless steel tubing "H" frames on 6' to 7' centers. Interconnecting cross rails are required. The intermediate section is a 1-1/2"x1-1/2" 12-gauge stainless steel angle frame 1-3/4" (4cm) O.D. PVC bearing supported stainless steel shaft mounted idler rollers on 4" (10cm)-0" centers. Exposed sides are fitted with removable stainless steel panels. The tail section consists of a stainless steel framework which houses tail roller and bracket guides. Stainless steel panels conceal frame where exposed.

### ALLUSERV, LLC

4900 West Electric Avenue | West Milwaukee WI | 53219

888-892-2213 | fax 636-239-8435 | [info@alluserv.com](mailto:info@alluserv.com) | [www.alluserv.com](http://www.alluserv.com)

# Fabric Belt Conveyor

## Models

FBC10, FBC12, FBC14, FBC16, FBC18, FBC20

### Options

- Electric Raceways- All units can be equipped with electric raceways for your electrical convenience.
- Outlets- Allows you to plug in all support equipment. No more drop cords. Single or three phase outlets are available in either straight blade or twist lock.
- Field Joint- Allows longer conveyors to be shipped and maneuvered to location in smaller sections.
- Movable Over Shelf- This option gives extra surface area and easy access for dietary meal kits and other tray requirements.
- Casters- These conveyors come standard with adjustable bullet feet. Casters can be added if electrical load per mits.
- Cord & Plug- Conveyors are constructed for hard wiring as standard, requiring electrical service at location. Ground receptacle required for this option. This option is available on any unit with electric amp load of 100 or less.
- 200 AMP Service Upgrade- Required for electrical service over 100 amps on the raceway. If this option is required the options of cord and plug, as well as casters, are not available.

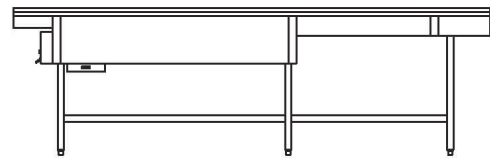
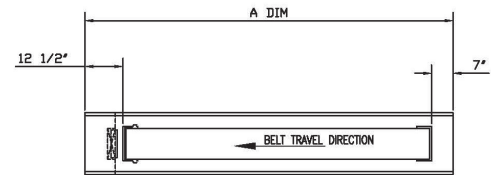
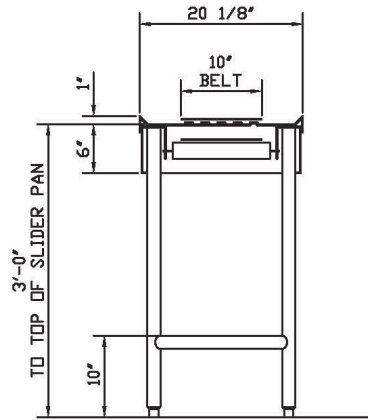

### MODEL INFORMATION

MODEL	A DIM	WIDTH	SHIP WEIGHT
FBC10	10 ft.	20-1/8"	740 lbs.
FBC12	12 ft.	20-1/8"	800 lbs.
FBC14	14 ft.	20-1/8"	860 lbs.
FBC16	16 ft.	20-1/8"	920 lbs.
FBC18	18 ft.	20-1/8"	980 lbs.
FBC20	20 ft.	20-1/8"	1040 lbs.



Spec #

AIA #